

* required information

Section 1 of 9

You can save the form at any time and resume it later. You do not need to be logged in when you resume.

System reference

Not Currently In Use

This is the unique reference for this application generated by the system.

Your reference

You can put what you want here to help you track applications if you make lots of them. It is passed to the authority.

Are you an agent acting on behalf of the applicant?

Yes No

Put "no" if you are applying on your own behalf or on behalf of a business you own or work for.

Applicant Details

* First name

Aldi Stores Limited

* Family name

Aldi Stores Limited

* E-mail

Main telephone number

Include country code.

Other telephone number

Indicate here if the applicant would prefer not to be contacted by telephone

Is the applicant:

Applying as a business or organisation, including as a sole trader
 Applying as an individual

A sole trader is a business owned by one person without any special legal structure. Applying as an individual means the applicant is applying so the applicant can be employed, or for some other personal reason, such as following a hobby.

Applicant Business

Is the applicant's business registered in the UK with Companies House?

Yes No

Note: completing the Applicant Business section is optional in this form.

Registration number

2321869

Business name

Aldi Stores Limited

If the applicant's business is registered, use its registered name.

VAT number

-

Put "none" if the applicant is not registered for VAT.

Legal status

Private Limited Company

Continued from previous page...

Applicant's position in the business

Home country

The country where the applicant's headquarters are.

Registered Address

Address registered with Companies House.

Building number or name

Street

District

City or town

County or administrative area

Postcode

Country

Agent Details

* First name

* Family name

* E-mail

Main telephone number

Include country code.

Other telephone number

Indicate here if you would prefer not to be contacted by telephone

Are you:

An agent that is a business or organisation, including a sole trader

A sole trader is a business owned by one person without any special legal structure.

A private individual acting as an agent

Agent Business

Is your business registered in the UK with Companies House? Yes No

Note: completing the Applicant Business section is optional in this form.

Registration number

Business name

If your business is registered, use its registered name.

VAT number

Put "none" if you are not registered for VAT.

Legal status

Continued from previous page...

Your position in the business

Home country

The country where the headquarters of your business is located.

Agent Registered Address

Address registered with Companies House.

Building number or name

Street

District

City or town

County or administrative area

Postcode

Country

Section 2 of 9

PREMISES DETAILS

Refer to the guidance notes while completing this form.

Premises licence number/club

premises certificate number

* Name of premises

Premises Location

* Are you able to provide a postal address, OS map reference or description of the premises?

Address OS map reference Description

* Building number or name

* Street

District

* City or town

County or administrative area

Postcode

* Country

Premises Contact Details

E-mail

Telephone number

Other telephone number

Continued from previous page...

* Brief description of premises (See Guidance Note 2)

Supermarket

Section 3 of 9

APPLICANT DETAILS

* Are you the premises licence holder/club premises certificate holder?

Yes No

Are the applicants address and contact details the same as the premises address and contact details given in section 2?

Yes No

Applicant Address

Is the address the same as (or similar to) the address given in section one?

Yes No

If "Yes" is selected you can re-use the details from section one, or amend them as required. Select "No" to enter a completely new set of details.

Building number or name

Street

District

City or town

County or administrative area

Postcode

Country

Applicant Contact Details

Are the contact details the same as (or similar to) those given in section one?

Yes No

If "Yes" is selected you can re-use the details from section one, or amend them as required. Select "No" to enter a completely new set of details.

E-mail

Telephone number

Other telephone number

Section 4 of 9

PROPOSED VARIATION

Would you like the variation to take effect from as soon as possible?

Yes No

Continued from previous page...

Do you want the proposed variation to have effect in relation to the introduction of the late night levy?

Yes No

See guidance note 3.

Describe the proposed variation(s) in detail in the box below and explain why you consider that they could not have an adverse effect on the promotion of any of the licensing objectives. (See Guidance Note 1) This should include whether new or increased levels of licensable activities will be taking place indoors or outdoors (indoors may include a tent).

Details of proposed variation(s) (See Guidance Note 4)

Amendment to the current approved plan to show a reconfiguration to the tills.

Section 5 of 9

OPERATING SCHEDULE

See guidance on regulated entertainment

Select those parts of the Operating Schedule which would be subject to change if this application to vary were successful (check all that apply)

Provision of regulated entertainment

- a. plays
- b. films
- c. indoor sporting events
- d. boxing or wrestling entertainments
- e. live music
- f. recorded music
- g. performance of dance
- h. anything of a similar description to that falling within (e), (f) or (g)

Provision of late night refreshment and alcohol

- i. late night refreshment
- j. sale by retail of alcohol

This can only relate to reducing licensed hours, or moving them without any overall increase between 7am and 11pm.

Section 6 of 9

ADDITIONAL INFORMATION

Are you able to submit the premises licence/club premises certificate (or relevant part)?

Yes No

Are you able to submit a copy of the plan?

Yes No

This is necessary if the proposed variation will affect the layout.

Continued from previous page...

Any further information to support your application. You should use this box to provide any additional evidence to support your claim that the proposed variation is 'minor' and could not have an adverse impact on the promotion of the licensing objectives.

N/A

Section 7 of 9

NOTES FOR GUIDANCE

Continued from previous page...

- Dance: no licence is required for performances between 08.00 and 23.00 on any day, provided that the audience does not exceed 500. However, a performance which amounts to adult entertainment remains licensable.
- Cross activity exemptions: no licence is required between 08.00 and 23.00 on any day, with no limit on audience size for:
 - o any entertainment taking place on the premises of the local authority where the entertainment is provided by or on behalf of the local authority;
 - o any entertainment taking place on the hospital premises of the health care provider where the entertainment is provided by or on behalf of the health care provider;
 - o any entertainment taking place on the premises of the school where the entertainment is provided by or on behalf of the school proprietor; and
 - o any entertainment (excluding films and a boxing or wrestling entertainment) taking place at a travelling circus, provided that (a) it takes place within a moveable structure that accommodates the audience, and (b) that the travelling circus has not been located on the same site for more than 28 consecutive days.

Section 9 of 9

PAYMENT DETAILS

This fee must be paid to the authority. If you complete the application online, you must pay it by debit or credit card.

This formality requires a fixed fee of £89

DECLARATION

* I understand it is an offence, liable on summary conviction to a fine not exceeding level 5 on the standard scale, under section 158 of the Licensing Act 2003, to make a false statement in or in connection with this application.

* I understand that if I do not comply with the requirements my application will be rejected.

* I understand that I must now advertise my application for a continuous period beginning on the first working day after the day on which the application was given to the relevant licensing authority and ending at the expiry of the tenth consecutive working day after that day.

Ticking this box indicates you have read and understood the above declaration

This section should be completed by the applicant, unless you answered "Yes" to the question "Are you an agent acting on behalf of the applicant?"

* Full name

* Capacity

* Date / /
dd mm yyyy

Once you're finished you need to do the following:

1. Save this form to your computer by clicking file/save as...

2. Go back to <https://www.gov.uk/apply-for-a-licence/premises-licence/staffordshire-moorlands/change-8> to upload this file and continue with your application.

Don't forget to make sure you have all your supporting documentation to hand.

IT IS AN OFFENCE, UNDER SECTION 158 OF THE LICENSING ACT 2003, TO MAKE A FALSE STATEMENT IN OR IN CONNECTION WITH THIS APPLICATION. THOSE WHO MAKE A FALSE STATEMENT MAY BE LIABLE ON SUMMARY CONVICTION TO A FINE OF ANY AMOUNT.

MECHANICAL & ELECTRICAL INSTALLATION
 For electrical work, lighting, emergency lighting, heating and ventilation refer to M & E Contractors drawings and specifications.
 All fire alarm systems to be installed in accordance with A.S. 5268
 Fire alarm systems to be installed in accordance with A.S. 5268 Part 1.
 1884.

- KEY TO FIRE FIGHTING EQUIPMENT AND SIGNS**
- 1 Fire alarm siren
 - 2 Fire alarm bell
 - 3 Fire alarm bell
 - 4 Fire alarm bell
 - 5 Fire alarm bell
 - 6 Fire alarm bell
 - 7 Fire alarm bell
 - 8 Fire alarm bell
 - 9 Fire alarm bell
 - 10 Fire alarm bell
 - 11 Fire alarm bell
 - 12 Fire alarm bell
 - 13 Fire alarm bell
 - 14 Fire alarm bell
 - 15 Fire alarm bell
 - 16 Fire alarm bell
 - 17 Fire alarm bell
 - 18 Fire alarm bell
 - 19 Fire alarm bell
 - 20 Fire alarm bell
 - 21 Fire alarm bell
 - 22 Fire alarm bell
 - 23 Fire alarm bell
 - 24 Fire alarm bell
 - 25 Fire alarm bell
 - 26 Fire alarm bell
 - 27 Fire alarm bell
 - 28 Fire alarm bell
 - 29 Fire alarm bell
 - 30 Fire alarm bell
 - 31 Fire alarm bell
 - 32 Fire alarm bell
 - 33 Fire alarm bell
 - 34 Fire alarm bell
 - 35 Fire alarm bell
 - 36 Fire alarm bell
 - 37 Fire alarm bell
 - 38 Fire alarm bell
 - 39 Fire alarm bell
 - 40 Fire alarm bell
 - 41 Fire alarm bell
 - 42 Fire alarm bell
 - 43 Fire alarm bell
 - 44 Fire alarm bell
 - 45 Fire alarm bell
 - 46 Fire alarm bell
 - 47 Fire alarm bell
 - 48 Fire alarm bell
 - 49 Fire alarm bell
 - 50 Fire alarm bell
 - 51 Fire alarm bell
 - 52 Fire alarm bell
 - 53 Fire alarm bell
 - 54 Fire alarm bell
 - 55 Fire alarm bell
 - 56 Fire alarm bell
 - 57 Fire alarm bell
 - 58 Fire alarm bell
 - 59 Fire alarm bell
 - 60 Fire alarm bell
 - 61 Fire alarm bell
 - 62 Fire alarm bell
 - 63 Fire alarm bell
 - 64 Fire alarm bell
 - 65 Fire alarm bell
 - 66 Fire alarm bell
 - 67 Fire alarm bell
 - 68 Fire alarm bell
 - 69 Fire alarm bell
 - 70 Fire alarm bell
 - 71 Fire alarm bell
 - 72 Fire alarm bell
 - 73 Fire alarm bell
 - 74 Fire alarm bell
 - 75 Fire alarm bell
 - 76 Fire alarm bell
 - 77 Fire alarm bell
 - 78 Fire alarm bell
 - 79 Fire alarm bell
 - 80 Fire alarm bell
 - 81 Fire alarm bell
 - 82 Fire alarm bell
 - 83 Fire alarm bell
 - 84 Fire alarm bell
 - 85 Fire alarm bell
 - 86 Fire alarm bell
 - 87 Fire alarm bell
 - 88 Fire alarm bell
 - 89 Fire alarm bell
 - 90 Fire alarm bell
 - 91 Fire alarm bell
 - 92 Fire alarm bell
 - 93 Fire alarm bell
 - 94 Fire alarm bell
 - 95 Fire alarm bell
 - 96 Fire alarm bell
 - 97 Fire alarm bell
 - 98 Fire alarm bell
 - 99 Fire alarm bell
 - 100 Fire alarm bell

- INDICATES 30 MINUTE FIRE BARRIER
- INDICATES SMOKE SEAL TO TOP OF SPINE WALL
- FIRE BOUNDARY CONDITION - 60MIN FIRE RESISTING WALL CONSTRUCTION MINIMUM. ALL EXPOSED STEEL & STEEL LANCES TO HAVE A MINIMUM 60 MINUTE FIRE RESISTION.
- INDICATES FIRE EXIT DIRECTION

COMPARTMENTATION:

- WAREHOUSE IS NOT A FIRE COMPARTMENT AND IS CLASSIFIED AS ANCLLARY USE TO THE RETAIL AREA
- PLATROOM IS A COMPARTMENT AND SHOULD BE 30MIN FIRE PROTECTED

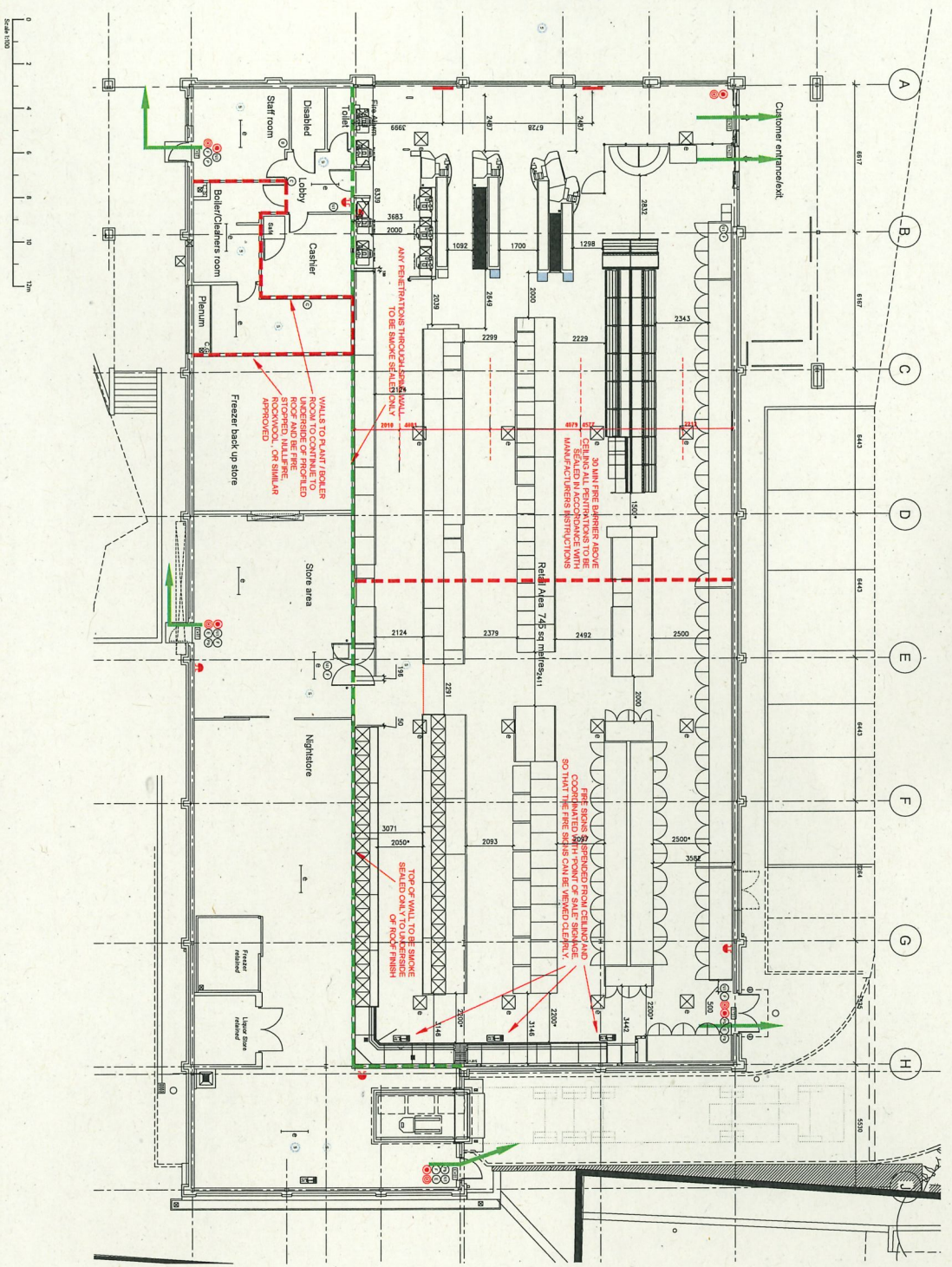

Scale: 1:500
 0 1 2 3 4 5 6 7 8 9 10 11m

STOAS Architects Ltd
WORKING DRAWING

PROJECT: STOAS STORES LIMITED
 LOCATION: HAYWOOD STREET
 DRAWING: FIRE STRATEGY PLAN

DATE: 20.03.24
 DRAWN: [Signature]
 CHECKED: [Signature]

STOAS